

What are RESCUE[®] Wipes?

Rescue[™] Wipes are powered by Accelerated Hydrogen Peroxide[®] (AHP[®]), a **CLEANER, FASTER, RESPONSIBLE, SUSTAINABLE, and COMPATIBLE** disinfectant technology. Rescue[™] Wipes are the only pre-saturated wipe designed to meet the specific needs of companion animal health.



Why choose Rescue[™] Wipes?

Improves productivity:

- Easy, convenient and effective way to improve patient turnover times
- Superior cleaning ability
- Tough on hard to kill pathogens in only **60 seconds!**

Gentle on animals, humans, planet and equipment:

- No PPE required
- Carries lowest EPA toxicity rating (category IV)
- Fear FreeSM approved to reduce fear, anxiety and stress in pets

When to use Rescue[™] Wipes?

Tough enough for outbreaks, but gentle enough to be used every day.

- Daily use on all hard, non-porous surfaces such as staff areas, exam rooms and low-risk environments
- Outbreak, quarantine or isolation areas, and other high-risk environments

Where can Rescue[™] Wipes be used?

For Use In:

- Animal housing facilities, shelters, and kennels
- Grooming facilities
- Pet stores
- Surgical suites and treatment facilities
- Transportation vehicles
- Veterinary practices and offices
- Other small animal facilities

For Use On:

Hard surfaces:

- Cage & spot cleaning
- Counters
- Desks
- Door & drawer handles
- Exam tables
- Faucets
- Food & water bowls*
- Light switches

Transportation areas:

- Dashboard
- Door handles

- Rear view mirror
- Steering wheel
- Stick shift

Devices & Equipment:

- Clipper handles
- Computer keyboards & mice
- Hose ends
- Microscope knobs
- Phones
- Oscopes
- Stethoscopes



How to Use RESCUE[®] Wipes

- ### 1 Remove lid and seal

Pull first wipe through the X opening on lid. Replace lid.

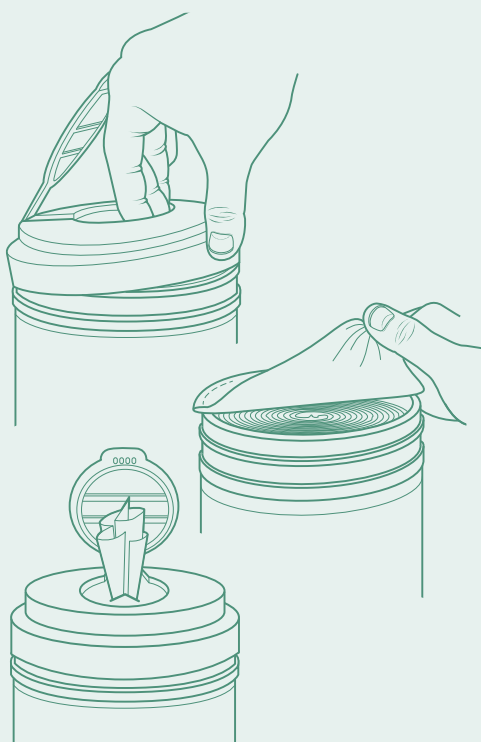

- ### 2 Clean

Remove visible soils (feces, urine, organic matter).

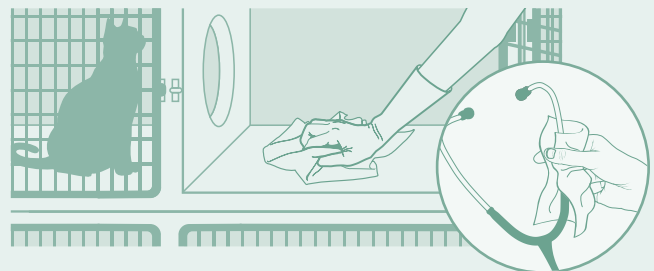

- ### 3 Wipe

Apply Rescue[™] Wipes to surfaces, making sure to wet surfaces thoroughly.



- ### 4 Disinfect

Wait 1 minute.**

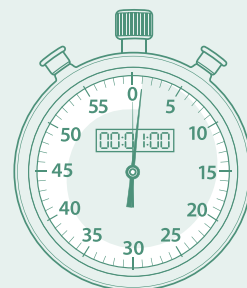

* Some surfaces may require rinsing.

** Refer to reference sheet for additional claims and use instructions.

EPA Reg No. 74559-10 | EPA Est. No. 74559-CAN-1